

# HID-PrimaVision Compact Built-in for CDM

HID-PV C 2x35 /S CDM 220-240V 50/60Hz

Compact, lightweight and easy to use high performance range of electronic gears for optimal performance of 35W, 70W, 100W and 150W CDM lamps



## Product data

### • Product Data

Order code	895728 00
Full product code	872790089572800
Full product name	HID-PV C 2x35 /S CDM 220-240V 50/60Hz
Order product name	HID-PV C 2x35 /S CDM 220-240V 50/60Hz
Pieces per pack	1
Packing configuration	12
Packs per outerbox	12
Bar code on pack - EAN1	8711500881892
Bar code on outerbox - EAN3	8727900895728
Logistic code(s) - 12NC	913700656866
Net weight per piece	0.271 kg

### • General Characteristics

Rated Number of Lamps	2 piece
Rated Ballast-Lamp Power	35
Rated Lamptype	CDM
Application code	Int. Earth Loop
Line Voltage	220-240 V
Line Frequency	50/60 Hz
Design	-
Housing	/S
Suitable for Outdoor use?	No

### • Operating Characteristics

Automatic restart	Yes
-------------------	-----

Constant wattage deviation	-3%/+3%
Inrush current Peak	33 (max) A
Inrush current Width	0.5 ms
Maximum ballast number on MCB	14 x
Mains voltage safety (AC)	-18%/+10%
Mains voltage performance (AC)	-10%/+6%
Operating frequency *	0.13 kHz
Overvoltage protection 320Vac	48 hr
PowerFactor 100% output power	0.95 -
Ignition switch-off time	20 min
Ignition Voltage	4.5 (max) kV
Hum and Noise level	Inaudible

### • Wiring Characteristics

Cable-Cap output-wires mutual	120 pF
Connector type	Insert
Wcs Ballast contacts	0.50-2.50 mm <sup>2</sup>

### • Temperature Characteristics

Active temperature protection	Yes
F-marking	Yes
T-case life	70 C
T-case maximum	80 (max) C
T-ambient	-20 (min), 55 (max) C
T-storage	-25 (min), 80 (max) C



asimpleswitch.com

# PHILIPS

sense and simplicity

# HID-PrimaVision Compact Built-in for CDM

## • Approval & Application Char's

EMI 9 kHz ... 300MHz	CISPR 15 ed 7.2
Vibrations	IEC 68-2-6 Fc
Bumps	IEC 68-2-29 Eb
CE marking	Yes
ENEC certificate	Yes
VDE certificate	No

VDE-EMV certificate	No
CB Certificate	Yes

## • Product Dimensions

Length A1	135.0 mm
Width B1	75.0 mm
Height C1	32.0 mm

## Dimensional drawing

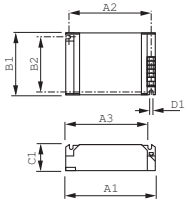

Product	A1 (Norm)	A2 (Norm)	A3 (Norm)	A4 (Norm)	B1 (Norm)	B2 (Norm)	B3 (Norm)	C1 (Norm)	D1 (Norm)
HID-PV C 2x35 /S CDM 220-240V 50/60Hz	135.0	-	-	-	75.0	-	-	32.0	-

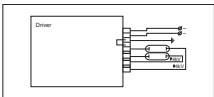

© 2011 Koninklijke Philips Electronics N.V.  
All rights reserved.

Specifications are subject to change without notice. Trademarks are the property of Koninklijke Philips Electronics N.V. or their respective owners.

[www.philips.com/lighting](http://www.philips.com/lighting)

2011, April 7  
data subject to change